

Carro de Empuje Manual 2 Tons Antiexplosion Antichispa

Especificaciones Técnicas

| | | | |
|------------------------|---------------------------------------|---------------|------------------------------|
| Prueba de Carga | 150% [Rated Load / Capacidad Nominal] | Normas | ASME B30.17 / ATEX Directive |
| Garantía | 3 Year | | |

| Capacity / Capacidad | A | B | C | D | E | F | H | I | J | K |
|----------------------|------------------|-----------------|-----------------|------------------|-----------------|------------------|------------------|----------------|----------------|-----------------|
| 1102 lb / 0.5 t | 7.50 in / 191 mm | 5.0 in / 127 mm | 2.9 in / 74 mm | 6.1 in / 155 mm | 2.7 in / 69 mm | 3.9 in / 99 mm | 4.2 in / 107 mm | 1.3 in / 33 mm | 1.1 in / 33 mm | 3.9 in / 99 mm |
| 2204 lb / 1 t | 8.70 in / 221 mm | 5.0 in / 127 mm | 2.9 in / 74 mm | 6.7 in / 170 mm | 3.1 in / 79 mm | 4.5 in / 114 mm | 4.4 in / 112 mm | 1.2 in / 30 mm | 1.1 in / 28 mm | 4.0 in / 102 mm |
| 3527 lb / 1.5 t | 10.2 in / 262 mm | 5.6 in / 142 mm | 3.7 in / 94 mm | 8.1 in / 206 mm | 3.8 in / 97 mm | 5.3 in / 135 mm | 5.9 in / 150 mm | 2.0 in / 51 mm | 1.5 in / 38 mm | 5.5 in / 140 mm |
| 4409 lb / 2 t | 10.2 in / 260 mm | 5.6 in / 142 mm | 3.7 in / 94 mm | 8.1 in / 206 mm | 3.8 in / 97 mm | 5.3 in / 135 mm | 5.9 in / 150 mm | 2.1 in / 53 mm | 1.5 in / 38 mm | 5.5 in / 140 mm |
| 6944 lb / 3 t | 11.3 in / 287 mm | 5.7 in / 145 mm | 3.8 in / 97 mm | 9.4 in / 239 mm | 4.5 in / 114 mm | 5.9 in / 150 mm | 7.1 in / 180 mm | 2.5 in / 64 mm | 1.9 in / 48 mm | 6.6 in / 168 mm |
| 11023 lb / 5 t | 12.9 in / 328 mm | 6.5 in / 165 mm | 4.9 in / 124 mm | 11.4 in / 290 mm | 4.9 in / 124 mm | 6.6 in / 167 mm | 8.7 in / 221 mm | 2.9 in / 74 mm | 2.3 in / 58 mm | 8.2 in / 208 mm |
| 17636 lb / 8 t | 17.0 in / 432 mm | 6.5 in / 165 mm | 7.0 in / 178 mm | 13.0 in / 330 mm | 6.2 in / 157 mm | 8.6 in / 218 mm | 9.6 in / 243 mm | 3.9 in / 99 mm | 3.1 in / 79 mm | 9.1 in / 231 mm |
| 22046 lb / 10 t | 17.0 in / 432 mm | 7 in / 178 mm | | 13.0 in / 330 mm | 6.2 in / 157 mm | 8.6 in / 218 mm | 9.6 in / 243 mm | 3.9 in / 99 mm | 3.1 in / 79 mm | 9.1 in / 231 mm |
| 33069 lb / 15 t | 22.8 in / 579 mm | 9 in / 229 mm | | 18.2 in / 462 mm | 7.7 in / 196 mm | 11.6 in / 295 mm | 10.7 in / 272 mm | 3.3 in / 84 mm | 3.7 in / 94 mm | 9.7 in / 246 mm |
| 44092 lb / 20 t | 22.8 in / 579 mm | 9 in / 229 mm | | 18.2 in / 462 mm | 7.7 in / 196 mm | 11.6 in / 295 mm | 10.7 in / 272 mm | 3.3 in / 84 mm | 3.7 in / 94 mm | 9.7 in / 246 mm |

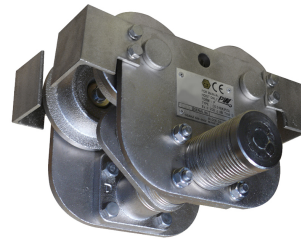
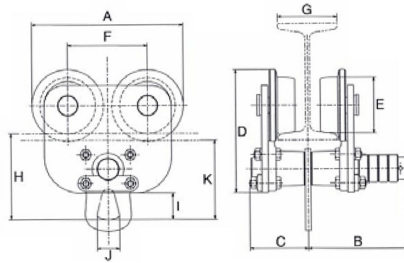

Referential Images
Specifications may change without notice

Detalles del Empaque

H Altura Muerta

15.83

Referential Images / Imágenes Referenciales
Specifications may change without notice / las especificaciones pueden cambiar sin previo aviso